

MADE IN ITALY



FLOODED									
Code	Voltage	Capacity	Cold Cranking	Res. Cap.	Terminal	Box	Bottom holds	Layout	Per Pallet
	V	Ah 20h	A (EN)	Minutes	Conical				
B117C	12	230	1350	490 (25A)	1 standard	C FLAT	B0	+ left	6x3=18

SAFE POWER TRUCK SHD

Classification EN50342-1			
W3	C2	V3	E3

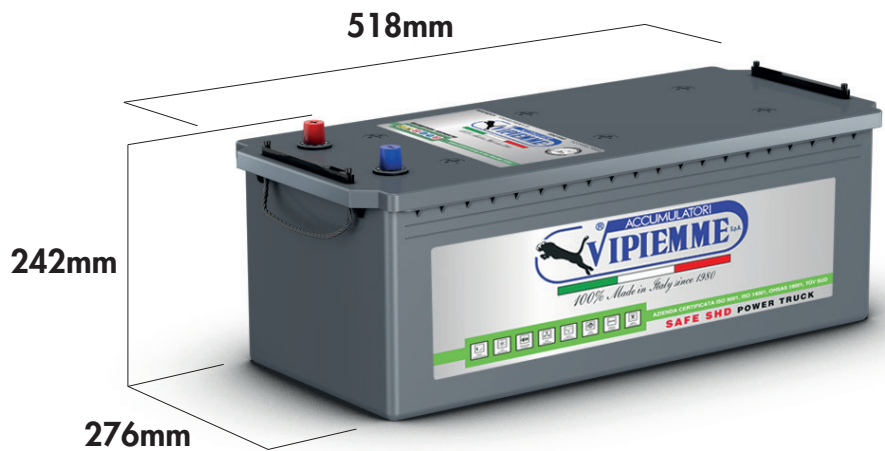

TECHNICAL CHARACTERISTICS



BOX AND LID
PP



FLAMES ARRESTOR
Placed in the Lid

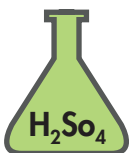

SULPHURIC ACID
Density
1,29+/- 0,01g/ml
Approximate volume 14,4 l

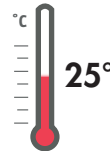

TEMPERATURE
According to EN50342-1



BATTERY WEIGHT
60,0 ±5% Kg

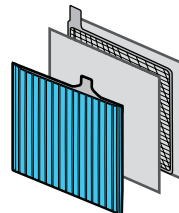

PLATES
Casted grids in Pb/Ca alloy
enveloped in PE with fiber glass

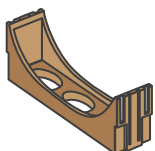

ANTI-VIBRATIONS DEVICES
Placed between the lid and the plates,
they make battery able to exceed
the vibration test. (up to 5 times V3
classification, according to EN50342-1)